

DR ACCESSORIES - ERRETI - GNS - SOTRALU
are companies of



DR ACCESSORIES

Zona Industriale Squartabue n.nc
62019 Recanati (MC)
ITALY
tel. +39 0717 506 174
info@ragni-fr.com
www.fraccessories.com

ERRETI

Via Pilastrino 32/B
48031 Bagnara di Romagna (RA)
ITALY
tel. +39 0545 283 811
sales@erreti.com
www.erreti.com

GNS

E.N. 1- Mouisca do Vouga
3754-901 Águeda
PORTUGAL
tel. +351 234 644 224
info@ingns.com
www.ingns.com

SOTRALU

151, avenue des Pyrénées
31600 Muret
FRANCE
tel. +33 5 34 46 06 00
contact@sotralu.fr
www.sotralu.fr

GNS.COM / DOORHINGEVENICEBABY7100B2024



Dobradiça de Porta 7100B

www.sotralugroup.eu



NOVA DOBRADIÇA DE PORTA
REF. 7100B



- › Dobradiça em alumínio para séries de câmara europeia. Desenvolvida para suportar cargas até 80kg, por cada dobradiça. Ajustação elíptica através da bucha.
- › Aluminum hinge for european chamber series. Developed to support loads up to 80kg per hinge. Adjustment elliptical tuning through the bushing.
- › Bisagra de aluminio para series de cámara europea. Desarrollada para soportar cargas elevadas. Afinación elíptica mediante el casquillo.
- › Paumelle en aluminium pour séries de chambre européenne. Conçue pour supporter des charges élevées. Ajustement elliptique par la bague.

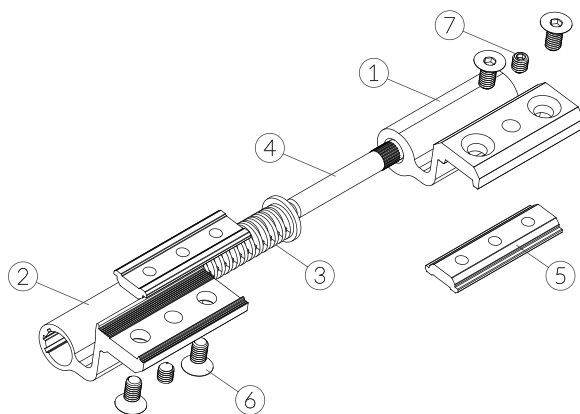
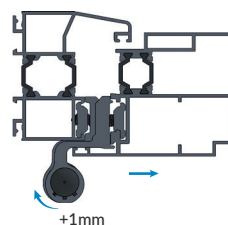
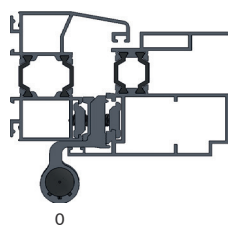
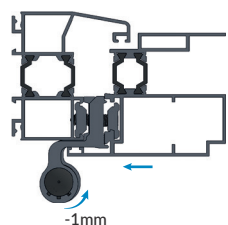

Nº	CÓDIGO - CODE	QTD
1	Aba Curva Curved Flap Pala Curva Plat Courbé	1
2	Aba Direita Right Flap Pala Derecha Plat à Droit	1
3	Bucha de Nylon Nylon Dowel Taco de Nylon Cheville en Nylon	1
4	Fiel Inox Faithful Stainless Steel Eje Inox Butée en Acier Inoxydable	1
5	Calço Shim Contra-Chapa Cale	2
6	DIN7991 - M6X12 A2	4
7	DIN914 - M6X8 A2	2

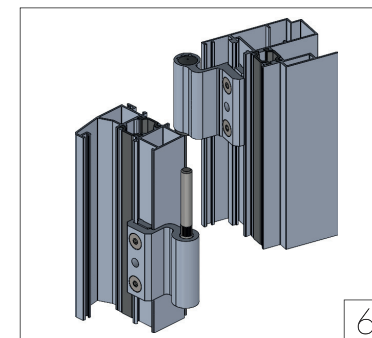
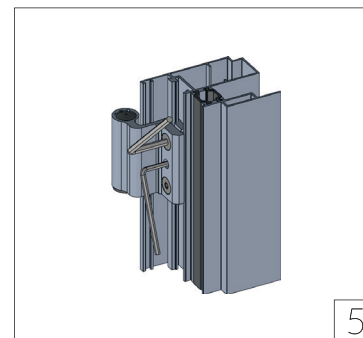
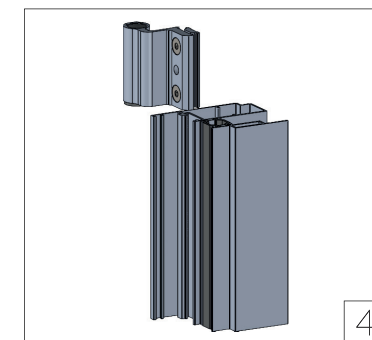
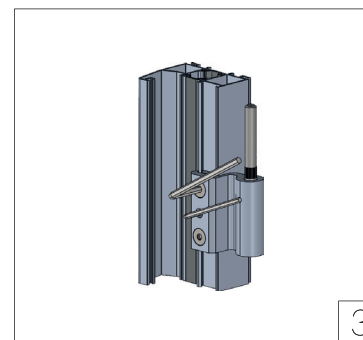
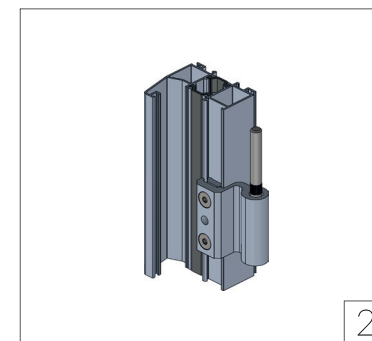
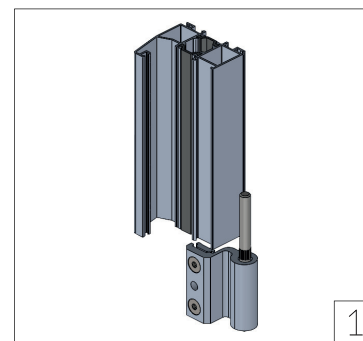

- › As dobradiças devem ser instaladas nas extremidades superior e inferior da porta para proporcionar um suporte adequado. As dimensões e o peso da porta não devem exceder os limites declarados, pois pode comprometer a integridade estrutural e a funcionalidade da porta.
- › The hinges should be installed at the top and bottom ends of the door to provide proper support. The dimensions and weight of the door must not exceed the stated limits, as it may compromise the structural integrity and functionality of the door.
- › Las bisagras deben instalarse en los extremos superior e inferior de la puerta para proporcionar un soporte adecuado. Las dimensiones y el peso de la puerta no deben exceder los límites declarados, ya que podría comprometer la integridad estructural y la funcionalidad de la puerta.
- › Les paumelles doivent être installées aux extrémités supérieure et inférieure de la porte pour assurer un support adéquat. Les dimensions et le poids de la porte ne doivent pas dépasser les limites déclarées, car cela pourrait compromettre l'intégrité structurelle et la fonctionnalité de la porte.